

**RBM SYSTEMS
PLUMBING
PRODUCT CATALOGUE**



RBM Systems Pty Ltd
PO Box 4104
Gumdale QLD 4154
Australia

ABN 86 640 763 239

+61 7 3073 2428

hello@rbmsystems.com.au
rbmsystems.com.au



RBM

PLUMBING PRODUCT CATALOGUE 2025

01. PLUMBING

Page

PRESSURE REDUCING VALVES	6
TEMPERING VALVES	11
THERMOSTATIC MIXING VALVES	11
SOLAR HOT WATER PROTECTION VALVES	13
POINT OF USE HARD WATER CONDITIONER	14
RESIDENTIAL HARD WATER CONDITIONER	15
COMMERCIAL HARD WATER CONDITIONER	16
SERVICE & ACCESSORIES	18



Code	Product Series	Page
PRESSURE REDUCING VALVES		
Series 2581.A	Rinox Plus M Adjustable Pressure Reducing Valve	6
Series 2581.B	Rinox Plus Smart M Adjustable Pressure Reducing Valve	6
Series 87.B	Rinox Due Adjustable Pressure Reducing Valve	10
Series 51.A	Rinox First HP Adjustable Pressure Reducing Valve	10
TEMPERING VALVES		
Series T08.A	T08 High Performance Tempering Valve	11
Series T08.B	T08 Tempering Valve with Isolation Elbows	11
THERMOSTATIC MIXING VALVES		
Series T16.A	T16 Commercial Thermostatic Mixing Valve	11
Series T16.B	Pre-plumbed Commercial TMV in Stainless Steel Cabinet	12
Series T55	T55 Health Series Thermal Flush TMV	12
SOLAR HOT WATER PROTECTION VALVES		
Series FPV	Frost Protection Valve	13
Series D06	Thermosyphon Arrestor Valve	13

Code	Product Series	Page
POINT OF USE HARD WATER CONDITIONER		
	ActivFlo Solo Shower Water Conditioner	14
	ActivFlo Nano Espresso Machine Water Conditioner	14
RESIDENTIAL HARD WATER CONDITIONER		
	ActivFlo - Residential Threaded	15
	ActivFlo - Residential Compression	15
COMMERCIAL HARD WATER CONDITIONER		
	ActivFlo - Commercial Threaded	16
	ActivFlo - Commercial Flanged	16
SERVICE & ACCESSORIES		
Series 8167	PRV Removable Cartridge	19
Series 1213	Radial Pressure Gauge	19
	T16 TMV 5-Year Service & Maintenance Kit	19



Series 2581.A

Rinox Plus M

Adjustable pressure reducing valve, diaphragm operated.

The internal cartridge can be easily inspected and extracted; provided with extractable filter.

Suitable for water channeling.

- Anti-dezincification brass body (CR).
Elastomer seals.
Threaded connections FF UNI-EN-ISO 228.
Pressure gauge holder connection F 1/4".
- Nominal pressure 25 bar (cold water 40 °C) / 16 bar (hot water 80 °C) *
 - Upstream pressure 25 bar (cold water 40 °C) / 16 bar (hot water 80 °C)
 - Adjustable downstream pressure 80 to 700 kPa
 - Max operating temperature 80 °C
 - Filtering grade 800 µm
 - Default presetting 500 kPa



Code	Measure	Pack	Outer
2581.04.00	G 1/2"	1	10
2581.05.00	G 3/4"	1	10
2581.06.00	G 1"	1	4
2581.07.00	G 1 1/4"	1	4
2581.08.00	G 1 1/2"	1	4
2581.09.00	G 2"	1	4



Pre-calibrated.
Replaceable cartridge.
Compact.



In order to avoid cavitation phenomena, and therefore excessive noise of the component, it is best to avoid having the ratio between the upstream maximum pressure and the downstream adjustment pressure of the regulator exceed a value of 2.5.



Series 2581.B

Rinox Plus Smart M

Adjustable pressure reducing valve, diaphragm operated, with measuring knob.

The internal cartridge can be easily inspected and extracted; provided with extractable filter.

Suitable for water channeling.

- Anti-dezincification brass body (CR).
Elastomer seals.
Threaded connections MM UNI-EN-ISO 228.
Pressure gauge holder connection F 1/4".
- Nominal pressure 25 bar (cold water 40 °C) / 16 bar (hot water 80 °C) *
 - Upstream pressure 25 bar (cold water 40 °C) / 16 bar (hot water 80 °C)
 - Adjustable downstream pressure 80 to 700 kPa
 - Max operating temperature 80 °C
 - Filtering grade 800 µm
 - Default presetting 500 kPa



Code	Measure	Pack	Outer
2581.04.90	G 1/2"	1	6
2581.05.90	G 3/4"	1	6
2581.06.90	G 1"	1	6
2581.07.90	G 1 1/4"	1	4
2581.08.90	G 1 1/2"	1	4
2581.09.90	G 2"	1	4



Pre-calibrated.
Replaceable cartridge.
Compact.
Complete with calibration knob.



In order to avoid cavitation phenomena, and therefore excessive noise of the component, it is best to avoid having the ratio between the upstream maximum pressure and the downstream adjustment pressure of the regulator exceed a value of 2.5.

RINOXPLUS M & RINOXPLUS SMART M

Diaphragm pressure reducing valves with inspectionable internal cartridge and removable filter.

The **RBM RinoxPlus M** are diaphragm operated pressure reducing valves with inspectionable and easily interchangeable internal cartridge, complete with removable filter.

The cartridge is a compensated seat: upstream pressure variations do not affect the adjustment of the downstream pressure.

In addition, the **RinoxPlusSmart M** pressure reducing valve is equipped with a graduated knob to carry out the calibration, without the use of a pressure gauge and tools.

SPARE PARTS AND MAINTENANCE INTERVENTIONS

Before carrying out any maintenance operation, shut off the pressure reducing valve.

For the replacement, control and cleaning of the reducer, simply unscrew the cap and remove the internal cartridge, which contains all the mobile parts and consumables.

When replacing the cartridge the reducer goes back to being like new.

It is possible to remove the filter from the cartridge to carry out cleaning or replacement.

During these operations, the body remains installed on the system.

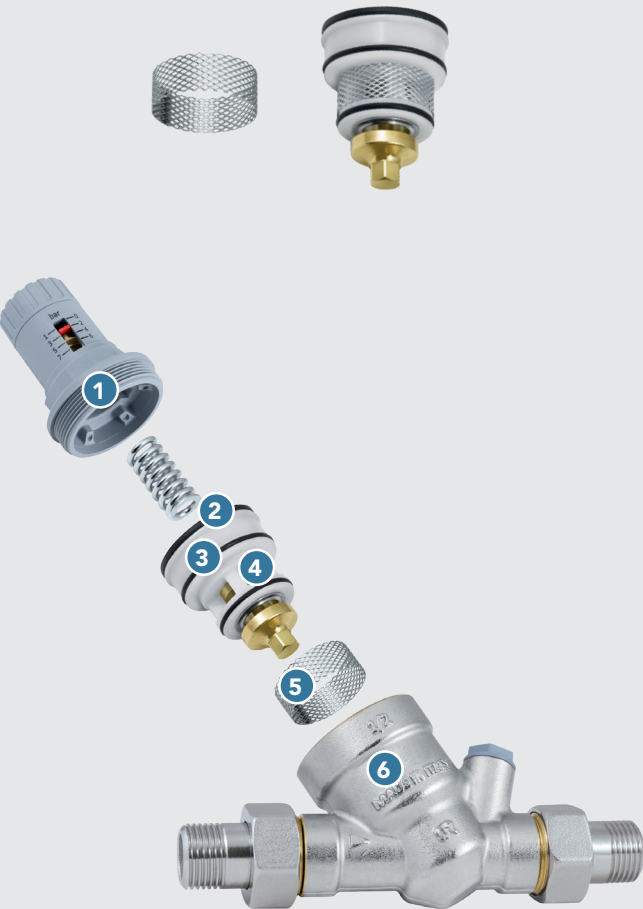

- 1 Polymer cap
- 2 Diaphragm made of elastomer
- 3 Additional sealing o-ring made of elastomer
- 4 Cartridge
- 5 Filter (800 micron)
- 6 Body made brass anti-dezincification (CR)



RINOXPLUS SMART M



RINOXPLUS M

- Diaphragm pressure reducing valve
- Inspectionable internal cartridge and filter
- Body made of brass anti-dezincification (CR)
- Out pressure calibration knob
- Cartridge compensated



RINOX

Compensated pressure reducing valves with double stainless steel seat. Diaphragm operated.

RBM Rinox pressure reducing valves are used in plumbing, heating and sanitary systems, especially to reduce pressure between the distribution network and the junctions of the main utility.

The structural features and diaphragm operation make **RBM Rinox** the ideal product to use in circuits in which upstream pressure can be subject to strong oscillations (water hammers).

The compensation chamber in the pressure reducing valve also prevents these fluctuations from affecting the calibration pressure, keeping it stable.

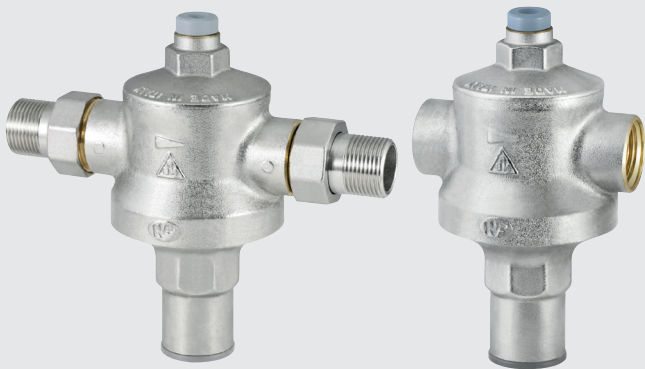

Compliant with EN 1567 and Approved **NF** (size 1/2" and 3/4").
Conformity **ACS**.

Moulded diaphragm (enhanced sensitivity - longer duration - greatly reduced friction)

Stainless steel double seal seat (protects moving parts - guides movement - enhanced adjustment sensitivity - not touched by scales)

PN 40 bar: ideal for installations in high rising buildings

Resistant to high temperatures: max operating temperature 80°C

Compensated: pressure variations upstream are compensated, leaving the outlet calibration constant

Wide application range

Can be installed in any position: vertical, horizontal, diagonal or facing downwards

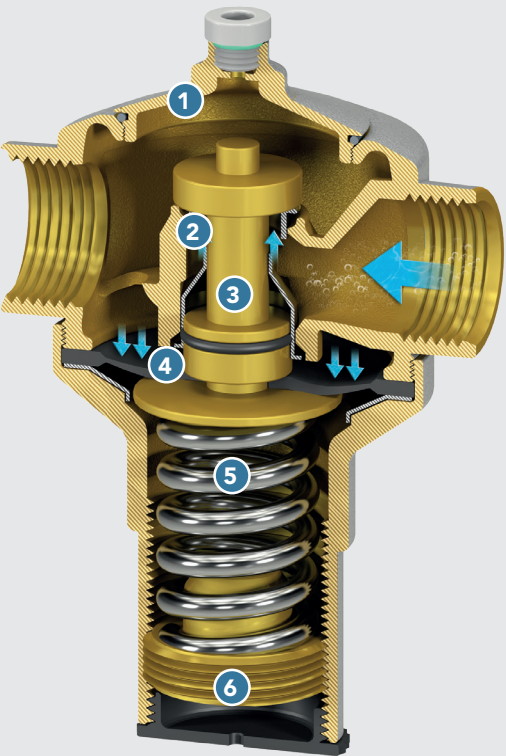

- 1 Pressure gauge holder connection
- 2 Stainless steel double seal seat
- 3 Compensation chamber
- 4 Diaphragm in moulded rubber
- 5 Adjustment spring
- 6 Calibration ring nut/screw

Representative section of the pressure reducing valve in the **CLOSED** position.

DIAPHRAGM PRESSURE REDUCING VALVES

Manufactured from top-quality materials, the **RBM Rinox** double-seated pressure reducing valve with diaphragm actuation is particularly suitable for reducing pressure between the distribution network and the main utility branch (from the urban network, power station supply, etc.).

RBM Rinox allows the transit of high flow rates with low pressure drops, absorbing water hammers from the external network thanks to the dampening action of the internal diaphragm. The reducing valve supports a nominal pressure of 40 bar*, allowing downstream pressure regulation between 0.8 and 10 bar (depending on the models). To achieve quiet operation and avoid premature wear of internal components, it is advisable to choose the reducing valve diameter so that the fluid velocity is within the following values:

- for water $V = 0.7-1.5$ m/s (residential use)
- $V = 1-3.5$ m/s (industrial use)

To avoid cavitation phenomena, and thus excessive component noise, the ratio between the maximum upstream pressure and the regulating pressure downstream of the regulator must not exceed 2.5.

For example, for an end-user supply setting of no more than 3 bar, the pressure upstream of the reducing valve must remain within 7.5 bar.

For higher values, it is advisable to insert a second reducing valve in series with the first, in order to spread the total pressure difference over two reduction jumps.

*** 25 bar for the RBM RinoxPlus M model**

Pressure stopped at the adjustment value of 3 bar

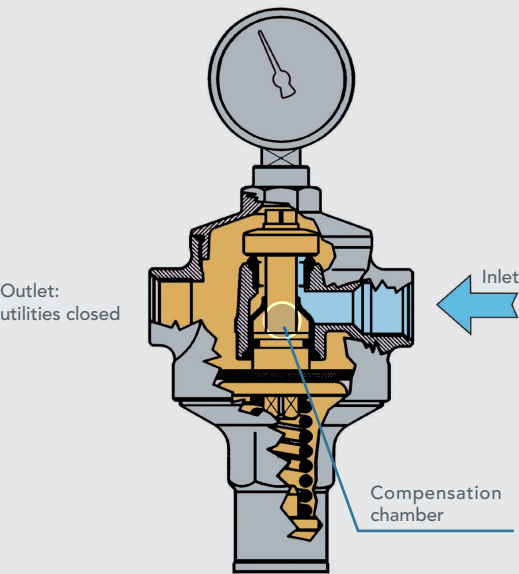

When the utilities to be served are closed, the downstream pressure increases by pushing the piston of the reducer to the bottom. In this way, the shutter closes the passage section of the pressure reducing valve, keeping the pressure constant at the set value set on the spring. The minimal pressure difference straddling the shutter allows it to close perfectly.

Pressure: $P < 3$ bar

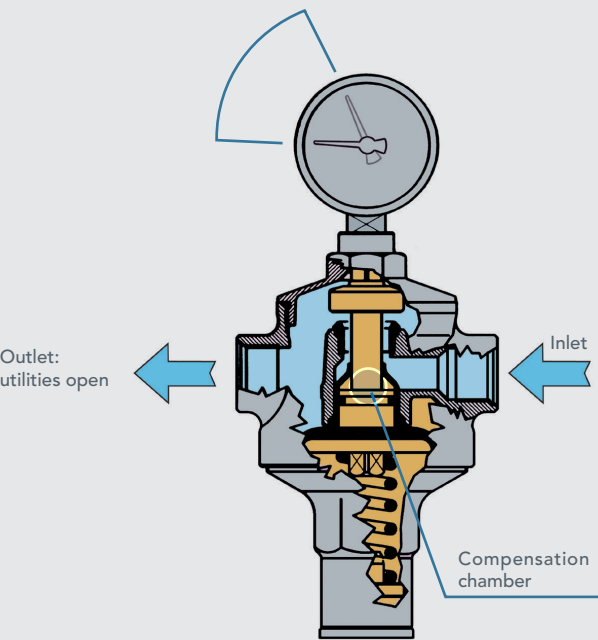

With the opening of the downstream utilities, the pressure exerted on the piston is less in favour of the force exerted by the spring on the shutter allowing its opening with the consequent fluid passage. The higher the demand for water from the utility network, the lower the pressure on the piston and the greater the water flow.



Series 87.B

Rinox Due

Adjustable pressure reducing valve, with single stainless steel seat and compensated piston operation. Suitable for water conveyance.

- Nickel brass body.
Stainless steel AISI 303 seat seals.
Elastomer seals.
Threaded connections FF UNI-EN-ISO 228.
F1/4" pressure gauge holder connection.
- Nominal pressure 25 Bar
 - Max upstream pressure 25 Bar
 - Adjustable downstream pressure 50 to 700 kPa (with inlet pressure of 800 kPa)
 - Max operating temperature 80 °C

Code	Measure	Pack	Outer
87.04.70	G 1/2"	1	20
87.05.70	G 3/4"	1	20
87.06.70	G 1"	1	6
87.07.70	G 1"1/4	1	6
87.08.70	G 1"1/2	1	1
87.09.70	G 2"	1	1



In order to avoid cavitation phenomena, and therefore excessive noise of the component, it is best to avoid having the ratio between the upstream maximum pressure and the downstream adjustment pressure of the regulator exceed a value of 2.5.



Series 51.A

Rinox First

Adjustable compensated pressure reducing valve, diaphragm operated, double seat, made of stainless steel, with anti-water hammer function. Suitable for water conveyance.

- Nickel brass body.
Stainless steel AISI 303.
Elastomer seals.
Threaded connections FF UNI-EN-ISO 228.
Pressure gauge holder connection F 1/4".
- Nominal pressure 40 Bar
 - Max upstream pressure 25 Bar
 - Max operating temperature 80 °C

Code	Measure	Pack	Outer
51.04.95	G 1/2"	1	6
51.05.95	G 3/4"	1	6
51.06.95	G 1"	1	6
51.07.95	G 1"1/4	1	4
51.08.95	G 1"1/2	1	1
51.09.95	G 2"	1	1

outlet adjustment 600 to 1,000 kPa



First reduction pressure reducing valve: this reduces upstream pressures near a value of 25 bar in compliance with the reduction ratio recommended by RBM.



In order to avoid cavitation phenomena, and therefore excessive noise of the component, it is best to avoid having the ratio between the upstream maximum pressure and the downstream adjustment pressure of the regulator exceed a value of 2.5.



Series T08.A

T08 High Performance Tempering Valves

RBM High Performance Tempering Valves are designed for quick and accurate regulation of hot water.

- Fluid: Water
- Maximum Static Pressure: 1400 kPa
- Maximum Dynamic Presssure: 500 kPa
- Hot Water Inlet Temperature: 55-99 °C
- Cold Water Inlet Temperature: 5-25 °C
- Controlled Temperature Range: 30 -50 °C
- Accuracy: ±2 °C
- Maximum Inlet Pressure ratio 2:1
- Minimum Flow Rate: 4 L/min



Code	Measure	Pack	Outer
T08T121-15HP	15mm	1	20
T08T191-20HP	20mm	1	20



Tempering valves supplied without insulation. 20mm model supplied with mixed outlet barrel union connection.



Series T08.B

T08 High Performance Tempering Valves with Isolation Elbows

- Fluid: Water
- Maximum Static Pressure: 1400 kPa
- Maximum Dynamic Presssure: 500 kPa
- Hot Water Inlet Temperature: 55-99 °C
- Cold Water Inlet Temperature: 5-25 °C
- Controlled Temperature Range: 30 -50 °C
- Accuracy: ±2 °C
- Maximum Inlet Pressure ratio 2:1
- Minimum Flow Rate: 4 L/min



Code	Valve	Elbows	Pack	Outer
T08T191-15TMV	20mm	15mm	1	20
T08T191-20TMV	20mm	20mm	1	20



Series T16.A

T16 Commercial Thermostatic Mixing Valves

RBM Thermostatic Mixing Valves are designed to maintain stable outlet temperatures even if inlet conditions vary.

- Fluid: Water
- Maximum Static Pressure: 1400 kPa
- Maximum Dynamic Presssure: 500 kPa
- Hot Water Inlet Temperature: 55-100 °C
- Cold Water Inlet Temperature: 5-25 °C
- Controlled Temperature Range: 30 -50 °C
- Factory Preset Temperature: 45 °C
- Accuracy: ±2 °C
- Maximum Inlet Pressure ratio 6:1
- Minimum Temperature Differential: 10 °C
- Minimum Flow Rate: 6 L/min



Code	Measure	Pack	Outer
T16T121-15TMV	15mm	1	20
T16T191-20TMV	20mm	1	20



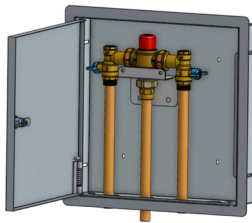

Series T16.B

T16 Commercial Pre-Plumbed TMV

RBM Thermostatic Mixing Valves are designed to maintain outlet temperature even if inlet conditions vary. Pre-Plumbed in Stainless Steel Cabinet with or without cold-water bypass.

- 3 Pipe = TMV with incoming and mixed outlet copper pipe connections.
- 4 Pipe = 3 Pipe connections as above with additional cold water bypass line.

T16 Commercial Pre-Plumbed TMV

Code	Size	Pipe	C/W Bypass	Pack	Outer
RBMS-21-0014	15mm	3	-	1	4
RBMS-21-0015	15mm	4	Yes	1	4
RBMS-21-0019	20mm	3	-	1	4
RBMS-21-0020	20mm	4	Yes	1	4

Stainless Steel Cabinet Only

Code	Features	Pack	Outer
RBMS-21-0059	Removable Face	1	4

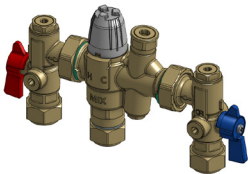

Series T55 Health

Thermal Flush TMV

T55 Thermostatic Mixing Valve features patented Thermal Flush disinfection capabilities. Designed for Health & Critical Care applications.

High flow design with low pressure drop. Suitable for up to 6 outlets.

Patented thermal flush disinfection process is tamperproof and adjustable.

Suitable for operation in low-pressure systems as low as 20 kPa supply.

- Fluid: Water
- Maximum Static Pressure: 1600 kPa
- Maximum Dynamic Pressure: 600 kPa
- Hot Water Inlet Temperature: 55-90 °C
- Cold Water Inlet Temperature: 5-30 °C
- Controlled Temperature Range: 35 - 50 °C
- Factory Preset Temperature: 43 °C
- Accuracy: ±2 °C
- Minimum Temperature Differential: 10 °C
- Minimum Flow Rate: 4 L/min

T55 Thermal Flush TMV

Code	Measure	Pack	Outer
T55T122-15TF	15mm	1	20
T55T192-20TF	20mm	1	20



Low-Lead Watermark Certified. WMK26384.



Series FPV

Frost Protection Valve

RBM Frost Protection Valves provide protection for Solar Collector Panels installed in low temperature climates.

Unique valve body extension piece to avoid heat transfer from collector panels.

- Maximum Static Pressure: 1000 kPa
- Maximum Temperature: 120 °C
- Accuracy: ±1 °C
- Opening Temperature: 3 °C
- Closing Temperature: 6 °C
- Water Drained: 1.5 lph

Code	Measure	Pack	Outer
PT-L0101	G 1/2"	1	60



Series D06

Thermosyphon Arrestor Valve

RBM Thermosyphon Arrestor Valves are designed to be fitted to a Thermosyphon Solar Hot Water System to limit the water temperature within the storage cylinder.

- Fluid: Water
- Maximum Static Pressure: 1400 kPa
- Maximum Inlet Temperature: 90 °C

Code	Measure	Pack	Outer
D06T120G-EV	G 3/4" + G 1/2"	1	15



ActivFlo

Water Conditioners

Single Point of Use Protection



ActivFlo SOLO
ActivFlo Solo water conditioner prevents limescale build-up in single appliances or motorhomes.

Code	Connection	Length	Pack
RBM-AF0012MF	1/2" BSP-M	80 mm	1



Motorhome or single appliance

ActivFlo SOLO
RBM-AF0012MF

3-14 litres per min



ActivFlo NANO
ActivFlo Nano water conditioner prevents limescale build-up in commerical coffee / espresso and commerical laundry machines.

Code	Connection	Length	Pack
RBM-AF0038MF	3/8" BSP-M	100 mm	1



Commercial Coffee / Espresso Machines

ActivFlo NANO
RBM-AF0038MF

1-11 litres per min

Technical Data:

Maximum operating temperature: 99°C
Maximum working pressure: 16 Bar (1,600 kPa)
Minimum supply pressure: 0.1 Bar (10 kPa)
Installation direction: Vertical or Horizontal

Insulation will be required for ambient temperatures below 0°C

Benefits:

- 15 Year manufacturer's guarantee
- Life span in excess of 20 years
- A complete fit and forget solution



Whole House Protection ActivFlo Residential



Whole house protection!



1-2 bedroom property
1-2 People

15mm ActivFlo Residential

3-22 litres per min
Max flow 33 lpm



3-4 bedroom property
3-5 People

20mm ActivFlo Residential

22-45 litres per min
Max flow 66.7 lpm



5-6 bedroom property
6-7 People

25mm ActivFlo Residential

45-74 litres per min
Max flow 102 lpm



ActivFlo Residential Threaded

ActivFlo provides whole house protection against limescale build-up, without the need for chemicals, electricity or magnets.

Code	Size	Pack	Outer
RBM-AF0012T	15 mm (1/2" BSP-M)	1	20
RBM-AF0034T	20 mm (3/4" BSP-M)	1	20
RBM-AF0100T	25 mm (1" BSP-M)	1	20



ActivFlo Residential Compression

ActivFlo provides whole house protection against limescale build-up, without the need for chemicals, electricity or magnets.

Code	Size	Pack	Outer
RBM-AF0015C	15 mm	1	20
RBM-AF0020C	20 mm	1	20
RBM-AF0025C	25 mm	1	20

Compression models supplied with copper olives and brass nuts.



Technical Data:

Maximum operating temperature: 99°C
Maximum working pressure: 16 Bar (1,600 kPa)
Minimum supply pressure: 0.1 Bar (10 kPa)
Installation direction: Vertical or Horizontal

Insulation will be required for ambient temperatures below 0°C

Benefits:

- 15 Year manufacturer's guarantee
- Life span in excess of 20 years
- A complete fit and forget solution



All pricing shown with * are typically not stocked in Australia and are indent only, please allow 12-14 working weeks availability. RBM reserves the right to make modifications and changes to the technical specifications without notice. Prices subject to change without notice. RBM General Conditions of Sale - Australia applies. All prices are in Australian Dollars and exclude GST. Pricing is per unit.

All pricing shown with * are typically not stocked in Australia and are indent only, please allow 12-14 working weeks availability. RBM reserves the right to make modifications and changes to the technical specifications without notice. Prices subject to change without notice. RBM General Conditions of Sale - Australia applies. All prices are in Australian Dollars and exclude GST. Pricing is per unit.

ActivFlo Commercial Hard Water Conditioners



Commercial property

ActivFlo Commercial up to 65mm BSP-Threaded





ActivFlo Commercial BSP-Threaded

ActivFlo provides protection against limescale build-up, without the need for chemicals, electricity or magnets in commercial buildings, apartments & irrigation systems.



Code	Connection	Flow Rate (lpm)
RBM-AF0114T	1 1/4" (32mm) BSP-M	75-117
RBM-AF0112T	1 1/2" (40mm) BSP-M	117-170
RBM-AF0200T	2" (50mm) BSP-M	170-264
RBM-AF0212T	2 1/2" (65mm) BSP-M	264-330



All threaded ActivFlo Commercial units are 550mm length.



Commercial property

ActivFlo Commercial up to 6" (150mm) Flanged



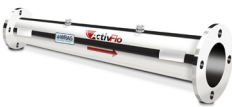

ActivFlo Commercial Flanged

ActivFlo provides protection against limescale build-up, without the need for chemicals, electricity or magnets in commercial buildings, apartments & irrigation systems.



Code	Connection	Flow Rate (lpm)
RBM-AF0300F	3" (80mm)	360-685
RBM-AF0400F	4" (100mm)	685-1,260
RBM-AF0500F	5" (125mm)	1,260-1,823
RBM-AF0600F	6" (150mm)	1,823-3,500



All flanged ActivFlo Commercial units are 850mm length.

Technical Data:

Maximum operating temperature: 99°C
Maximum working pressure: 16 Bar (1,600 kPa)
Minimum supply pressure: 0.1 Bar (10 kPa)
Installation direction: Vertical or Horizontal

Insulation will be required for ambient temperatures below 0°C

Benefits:

- 15 Year manufacturer's guarantee
- Life span in excess of 20 years
- A complete fit and forget solution



HARD WATER AREAS IN AUSTRALIA

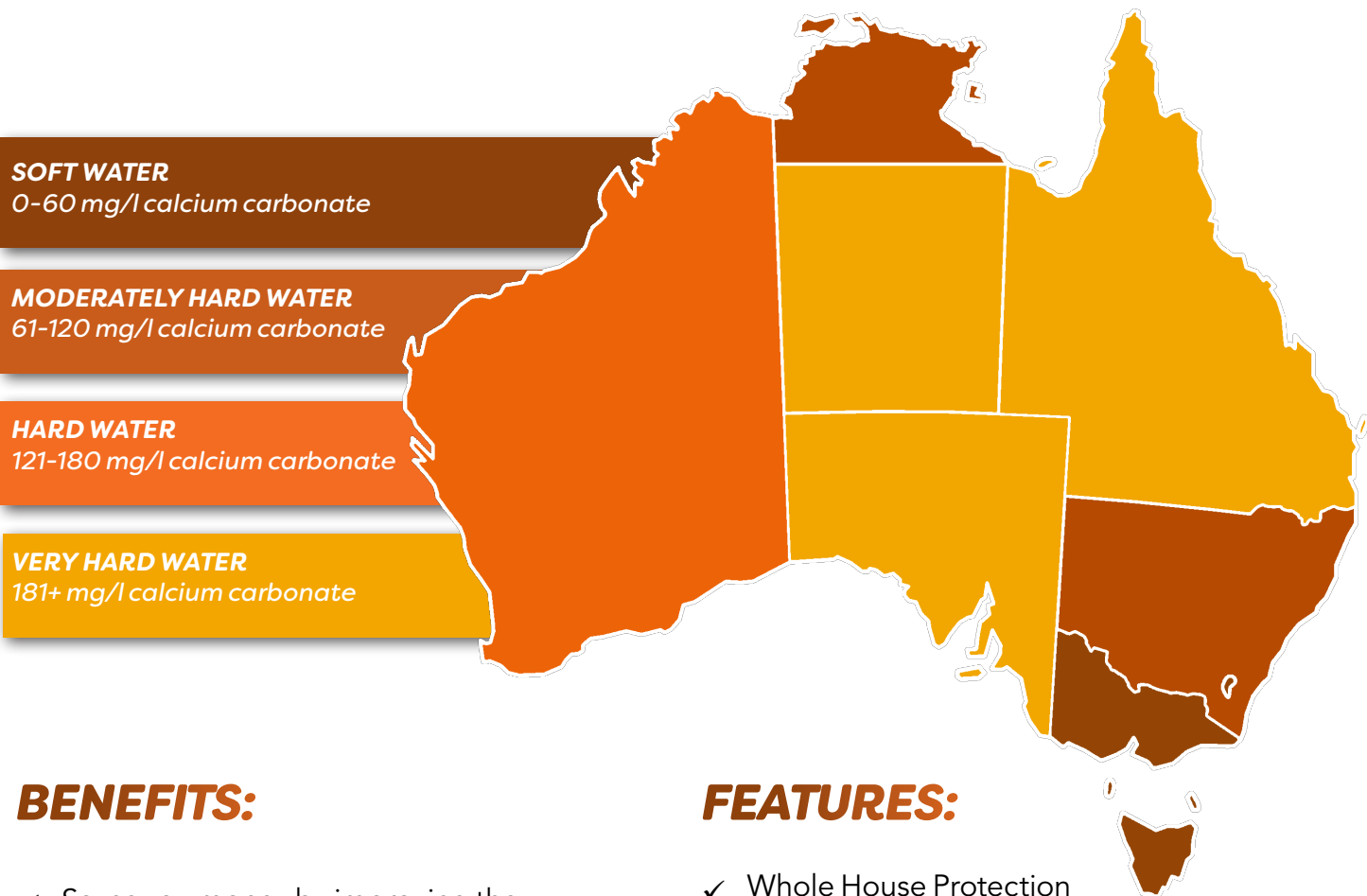

BENEFITS:

- ✓ Saves you money by improving the efficiency of heat sources and key system components
- ✓ Prevents premature component breakdown
- ✓ Reduces limescale spotting and residue on glassware and counter tops
- ✓ Maintains the health benefits of calcium carbonate in our natural water
- ✓ Space saving, ActivFlo takes up very little space in your home
- ✓ No power or maintenance required, a true fit & forget solution to hard water

FEATURES:

- ✓ Whole House Protection
- ✓ 15 Year Manufacturers Guarantee
- ✓ Operational Lifespan in excess of 20 years
- ✓ Quality 316 grade stainless steel
- ✓ WaterMark approved and certified to Australian standards



RBM
SERVICE & ACCESSORIES

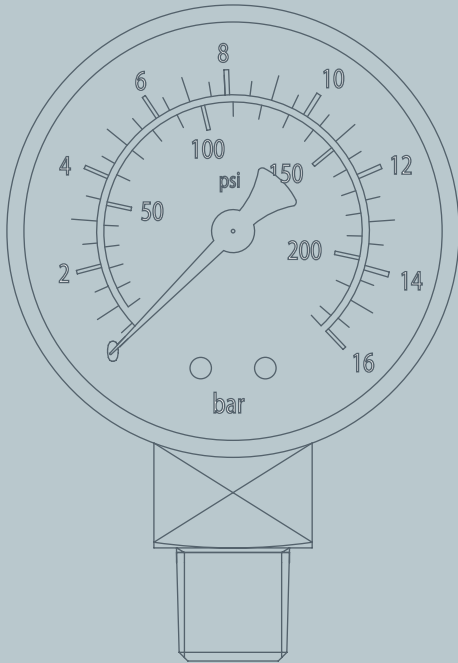

Series 8167
Removable Cartridge
Removable Cartridge complete with 800 micron filter for Rinox Pressure Reducing Valves

Compatible systems:
Rinox Plus M
Rinox Plus Smart M

Code	PRV Model Sizes	Pack
8167.003	1/2" - 3/4"	1
8201.003	1"	1
8202.003	1 1/4"	1
8203.003	1 1/2" - 2"	1



Series 1213
Radial Pressure Gauge
Radial Pressure Gauge 0 - 16 Bar.
1/4" BSP-M bottom entry connection.

Compatible systems:
Rinox Plus M
Rinox Plus Smart M

Code	Measure	Connection	Pack
1213.005	Ø 50	1/4"	1

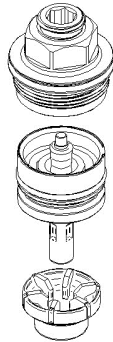

RBM T16 TMV
5-Year Service & Maintenance Kit

Kit Contains:

- Sealing element kit
- Shutter kit including o-ring, thermostatic element and spring
- Ferrule/Rod kit

Code	Pack
RBMS-21-0052	1





RBM Systems Pty Ltd
PO Box 4104
Gumdale QLD 4154
Australia

ABN 86 640 763 239

+61 7 3073 2428

hello@rbmsystems.com.au
rbmsystems.com.au